

**ADDENDUM 1  
ASBESTOS ABATEMENT WORK PLAN**

**BOERNE INDEPENDENT SCHOOL DISTRICT  
OLD ADMINISTRATION BUILDING  
123 JOHNS ROAD  
BOERNE, TEXAS 78006**

**STC PROJECT 220469  
ORIGINAL WORK PLAN: OCTOBER 28, 2022  
DATE OF ADDENDUM 1: NOVEMBER 28, 2022**

**ADDITIONAL CLARIFICATIONS**

Additional clarifications to the scope of work for the project are presented in the outline below:

1. The removal of the entire metal, window frame system during the asbestos abatement is authorized for this project.
2. The Asbestos Abatement Contractor is responsible for building security following the component removal of the window frame system. The building shall be secured with plywood or OSB panels with a minimum thickness of ¼”.
3. The Asbestos Abatement Contractor is responsible for the demolition of the 270 ft<sup>2</sup>, non-asbestos-containing CMU block wall located in the vault. The demolition of this wall is necessary to access the asbestos-containing, vinyl floor tile system enclosed between the vault wall and the exterior wall of the building.

A Quote Sheet for the asbestos-abatement activities noted in the Work Plan and for the above-mentioned tasks is attached. A revised floor plan is presented in the attached Figure 1B. Questions concerning this Addendum should be directed to our office at (210) 696-6286.

**Respectfully,**

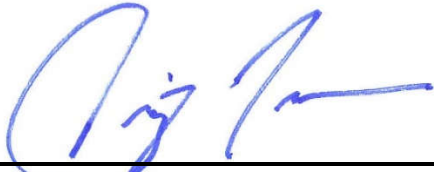

---

**Craig G. Tribble  
President  
Texas Asbestos Consultant Number 10-5701**

**Attachments: Quote Sheet  
Figure 1B – Revised Floor Plan**

**BOERNE INDEPENDENT SCHOOL DISTRICT  
OLD ADMINISTRATION BUILDING  
QUOTE SHEET  
STC PROJECT 220469  
NOVEMBER 28, 2022**

QUOTE SUBMITTED BY: \_\_\_\_\_  
(Name of Quoter)

DATE: \_\_\_\_\_

TO: Boerne Independent School District  
c/o Mr. Mark Stahl  
235 Johns Road  
Boerne, Texas 78006

RE: Old Administration Building  
123 Johns Road  
Boerne, Texas 78006

Ladies and Gentlemen:

The undersigned, on behalf of the herein named Asbestos Abatement Contractor, in compliance with your Invitation for Quote and being familiar with all of the conditions surrounding the scope of work of the proposed project, hereby offers to furnish all labor, materials, tools, equipment, transportation, waste disposal, supplies, insurance, permits, fees, taxes and services necessary to complete the work in accordance with the conditions of this quote and the Asbestos Abatement Work Plan. The Contractor agrees that claims for additional compensation or extensions of time because of its failure to familiarize itself within the location or any condition which might affect the work will not be allowed.

The workdays estimated to complete the project has been specified as part of this quote submitted for this location. The DSHS notification will be the responsibility of the Asbestos Abatement Contractor.

The undersigned hereby affirmatively states that it has not participated in any act of collusion, favoritism, gratuity or inside dealings with any member of the staff of BISD.

The undersigned agrees that BISD has the right to accept or reject any and/or all quotes and to waive irregularities or formalities in any Quote received.

**Boerne ISD – Old Administration Building:** The Contractor agrees to execute all the work for this Location for a total sum

of \_\_\_\_\_ and \_\_\_\_\_/100

Dollars (\$ \_\_\_\_\_). Estimated days to complete are \_\_\_\_\_

**UNIT PRICES:** The following unit prices must be filled in by the Contractor. These unit prices must be used by the Contractor to determine the total sum of the stipulated quote. These unit prices will also be the basis for any additional quantities removed or to reduce total sum if less material is removed.

<u>Base Quote</u>	<u>Unit Cost</u>	<u>Quantity</u>	<u>Total</u>
<b>Mobilization/Demobilization for Abatement Activities</b>	\$ _____ /event	x 1 event =	\$ _____
Abate asbestos-containing, beige, 9"x9", vinyl floor tile with black mastic located underneath carpet – IT Server Room	\$ _____ / ft <sup>2</sup>	x 300 ft <sup>2</sup> =	\$ _____
Demolish non-asbestos-containing, CMU block wall – Vault	\$ _____ / ft <sup>2</sup>	x 270 ft <sup>2</sup> =	\$ _____
Abate asbestos-containing, 9"x9", vinyl floor tiles with black mastic - Vault	\$ _____ / ft <sup>2</sup>	x 45 ft <sup>2</sup> =	\$ _____
Abate asbestos-containing window glazing on 670 panes approximately 40"x16" in size – Component removal of entire metal frame system	\$ _____ / ft <sup>2</sup>	x 525 ft <sup>2</sup> =	\$ _____
Secure building with a minimum of ¼" plywood or OSB panels following component removal of windows	\$ _____ / job	x 1 job =	\$ _____
Abate asbestos-containing window caulking between metal frame and brick veneer in eight (8) locations	\$ _____ / ft <sup>2</sup>	x 6 ft <sup>2</sup> =	\$ _____
<b>Total Quote</b>			<b>\$ _____</b>
<b>Days to Complete</b>			<b>_____ Days</b>

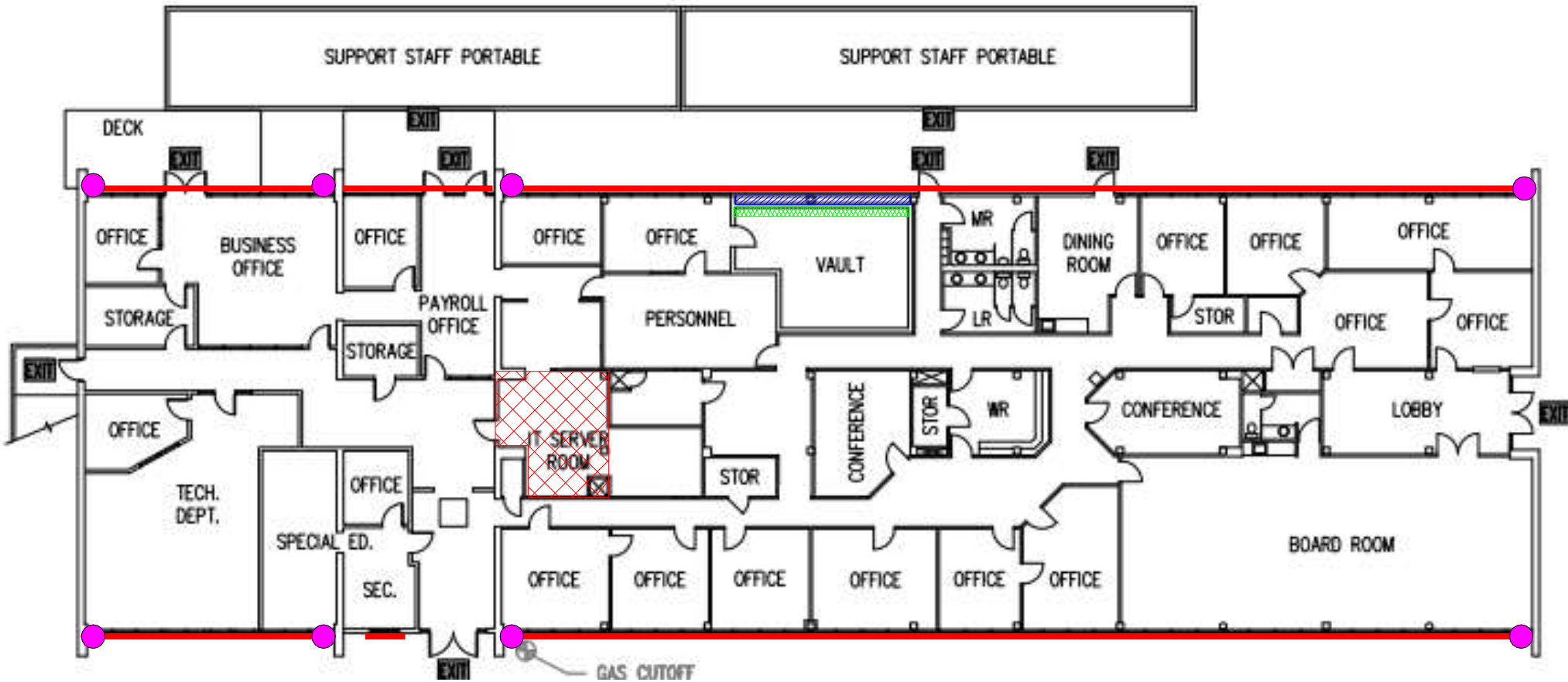

**LEGEND**



Beige, 9"x9", VCT with Black Mastic - Underneath Carpet  
Approx. 300 SF



9"x9", VCT with Black Mastic - Void Space Between CMU  
Block Wall and Exterior Windows - Approx. 45 SF



Demolish Non-Asbestos-Containing, CMU Block Wall  
Approx. 270 SF



Window Glazing - Approx. 525 SF or 670 Window Panes (40"x16")  
Component Removal of Entire Metal Frame System is Authorized



Window Caulking - In Between Metal Window Frame and  
Exterior Brick Veneer - Approx. 6 SF - Eight (8) Separate Areas

NOTE: Asbestos Abatement Contractor is Responsible for Building  
Security Following Window Removal - Minimum 1/4" Plywood or  
OSB Panel

*M*

